

EV200 Series Electric Vertical Level Control Switch

Application – High & Low Liquid Level Control; WP 250 psig

- Float-actuated Electric Vertical Switch for High & Low Liquid Level Control
- Provides Electric Switch input for control systems, alarms or other switch operations
- Low Specific Gravity of .7 and above
- Use on production separators, heaters/treaters, scrubbers, liquid accumulators & process vessels

Features and Benefits of the Pathway EV200

- 316 SS wetted components for Durability and Corrosion Resistance
- Explosion Proof Certification by CSA to USA and Canada Standards
- Single Seal Application Approved
- Hermetically Sealed Switch Cartridge to protect Integrity of Switch Contacts
- SPST and SPDT Switch Cartridges in Standard and Light Load Ratings
- No Internal Seal thus eliminating the possibility of process fluid leakage
- Normally Open or Normally Closed Operation
- Float options and Float Arm extensions to meet most applications
- Few Moving Parts for Reduced Maintenance and long term Performance
- Excellent Serviceability including Quick Replacement of Electric Switch Cartridge
- Relay Assemblies in Explosion Proof enclosures for DPDT and Higher Amperage service



Specifications

<p>Working Pressure: 250 psig Temperature: -40° F to +392° F Specific Gravity: 0.7 minimum Switch Rating:</p>	<p><u>SPST and SPDT</u> 250V – 0.40A resistive, 120V – 0.83A resistive, 24V – 3.0A resistive; 3.0A maximum in-rush capability; 4 watts minimum for proper switching <u>SPST and SPDT Light Load</u> 150V – 0.17A resistive, 110V – 0.23A resistive, 24V – 1.0A resistive; 1.0A maximum in-rush capability; 0.1 watts minimum for switching</p>
<p>Materials: Process Connection: Electrical Connection: Certification:</p>	<p>316 Stainless Steel Wetted components; Hermetically sealed reed switch 1½” NPT standard, 2” NPT, 2” flanged or larger ½” NPT conduit CSA: Class I, Div. 1, Groups A, B, C, D; Class II, Div. 1, Groups E, F, G; Class III, Div. 1 to USA & Canada Standards; (<i>rating with relay enclosure Class I, Div. 1&2, Groups C,D; Class II, Div. 1, Groups E,F,G; Class II, Div. 2, Groups F,G; Class III</i>) CSA: Single seal applications per ANSI/ISA 12.27.01-2003</p>

EV200 Common Options

- 316 SS and 304 SS flange
- Variety of float extensions and floats
- Float arm turbulence protective guide
- SPST extended leads
- Relay for DPDT and Higher Amperage

Benefits of ALL Pathway Control Products

- Personalized service and support expertise; Responsive, On-time Delivery
- Time-tested & proven design providing Dependable, Long-term service

EV200 Series

Electric Vertical Level Control Switch

Dimensions:

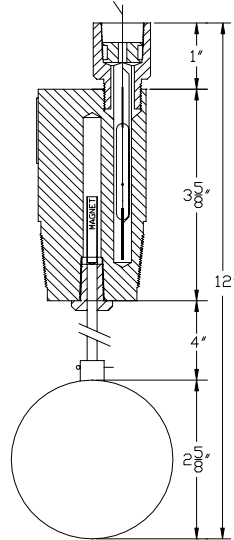

Ordering Chart:

EV200 Series: Electric Vertical Level Control Switch; WP 250 psig

Body Style:

- 0 1½" NPT, standard body, normally open
- 1 2" NPT, normally open
- 2 1½" NPT, normally closed
- 3 2" NPT, normally closed

Displacer Type:

- 1 3" O.D. 316 SS standard float with 4" float arm
- 2 3" O.D. 316 SS float, extended arm 4+" to 12" (specify length)
- 3 3½" x 6", 316 SS float, extended arm 12" to 36" (specify length)
- 4 5½" O.D. 316 SS float, extended arm 36" to 72" (specify length)
- 5 5½" O.D. 316 SS float, extended arm 72" to 96" (specify length)
- 5 Optional float sizes and float arm extensions (Customer to specify)

Switch selection:

- 0 SPST Standard load
- 1 SPDT Standard load
- 2 SPST Light load
- 3 SPDT Light load

Other:

- 0 No other options selected
- 1 Float arm turbulence protective guide
- 3 Relay assembly general purpose plug-in, 24VDC DPDT 12 Amp
- 4 Relay assembly general purpose plug-in, 120VAC DPDT 12 Amp
- 7 Relay assembly general purpose plug-in, 240VAC DPDT 12 Amp
- 8 Relay assembly hermetically sealed plug-in, 24VDC DPDT 12 Amp
- 9 Relay assembly hermetically sealed plug-in, 120VAC DPDT 12 Amp
- 5 Customer Specified Requirements (see EV200 common options)

Option (#) Assigned # for Customer Specific requirements

Example:

EV200-

0

1

0

1

EV200 - 01 - 01

Example as Selected